

Track Trenchers & Rock Saws



Tesmec USA

The new Tesmec 1375 Bucket Wheel, with its versatile options allows customers to best utilize one machine for various projects. From the powerful 540 hp C-15 Cat engine to the three operator selectable wheel speeds, Tesmec knows how to build a

Bucket Wheel for various material applications. Pipeliners already know that when it comes to reliable and productive Bucket Wheels, Tesmec is the choice of the industry. (800) 851-5102, tesmec.com

Mid America Trenchers

The Buckeye 9200T is designed for 16-inch and smaller diameter



pipeline. With its 600 hp available engine and a starting weight of 85,000 pounds, it is a machine with not only production but also maneuverability in mind. Both 7- and 9-foot digging wheels are available in several widths. With a quick

attach digging wheel option, different digging wheels can be swapped out in a matter of hours instead of days. (866) 376-8453



Vermeer

The T655 Commander 3 is for when tough working conditions demand trenching up to 8 feet of solid rock. A 250-hp John Deere 6090 HF485 emission engine delivers the power a crew needs to produce rock-solid results. With an 8-foot boom option and 40-inch end idler, more power is delivered

from this small machine. (888) 837-6337, vermeer.com

Trencor/Astec

The T1460 is a 630-hp, track-driven trencher with four digging chain speeds to suit varied digging conditions. Trencor uses a power-



shift transmission with torque converter to assure maximum torque to the digging chain. The T1460 can dig to depths of 8 feet through 18 feet and widths from 14 to 54 inches. Specifications list the crawler drive and steering as an infinitely variable hydrostatic/mechanical system

for speeds from 0 to 1 mph and separate hydrostatic transmission for each track. Tracks may be counter-rotated for good maneuverability. (800) 527-6020, astecunderground.com



Rivard Trenching USA

The RIV 300 TR 130 is the smaller of the trenching machines offered by Rivard. This 14 ton machine is ideal for trenching in tight areas, such as along side a thin stretch of highway. It is especially use-

ful for laying drainage pipe or duct, where the depth need only be around 40 inches. The suspended cab is mounted on a smaller B2 type crawler track, enabling the machine to move more easily in confined spaces. (610) 909-1905, rivardtrenching.net



Trench-Tech

The TT-2000 Chain Trencher boasts more digging torque with the Caterpillar C-9 electronic diesel engine providing 275 hp at 2,100 rpm. The trencher's digging capacity options include: boom options 6, 8 and 10 feet; depths provided by sectionalized single or double chain boom systems. Cutting width options include: single chain, 12-18 inches; double chain 20-36 inches with 4501/4502 type

chains. The TT-2000 features a 12-foot Arc type conveyor with variable discharge speed – shiftable in either direction for precise spoil placement, using three-ply heavy-duty belting material. The crawler track system is made of heavy duty OEM 300 series lubricated sealed track and roller system with 23.6-inch Grouser with mud relief holes. (817) 491-0621, trenchtech.com



The Charles Machine Works

The Ditch Witch HT220 hydrostatic trencher is built to provide exceptional digging in both rock and dirt. With 220 hp, it is designed for large installations – 12 to 24 inches wide and 4 to 8 feet deep – the machine has an

exclusive flywheel gearbox that delivers tremendous horsepower to the attachment on demand while protecting the hydraulic system and other components from shock. Operator vibration is further minimized by standard trencher stabilizers that isolate vibration when digging in rock. (800) 654-6481, ditchwitch.com



Mastenbroek

Mastenbroek trenchers are joined by the HRT (Hard Rock Trencher) range, capable of excavating trenches up to 17 feet in depth and 6.6 feet wide. Unlike conventional trenchers where a rear-mounted digging

boom is pulled onto the rock face, the fully patented HRT puts the reciprocating boom at the front of the machine, pushing an endless cutting chain into the bottom of the trench to create an undercut. The cutting head is then progressively raised through the material until it breaches the surface, at which point the boom is then lowered and the cycle repeated to excavate the desired depth and width. +44 (0) 1205 3111313, mastenbroek.com

Padding\Spoils Handling



Ozzie's Pipeline Padder

The Mini Padder is the solution for those who need a padder for small, cross-country or distribution pipeline work. The padder is attached to either a John Deere 755C or 655C track loader. The Mini Padder's elevator has a hydrostatic vibrating screen and is operator controlled. The screen area is 25-square-foot. Another feature is the variable speed bi-directional conveyor. (480) 585-9400, ozzies.com

controlled. The screen area is 25-square-foot. Another feature is the variable speed bi-directional conveyor. (480) 585-9400, ozzies.com

EZ Pipeline Padding

The EZ-4, EZ-7, EZ-8 and EZ-9 models are available from EZ Pipeline Padding (custom models are also available). The smaller machines can be attached to rubber tire loaders or backhoes. The soil separator unit mounts on the "C" frame of the dozer after the blade is removed at the same attaching points as the blade and hydraulic power unit



mounts on the back end of the dozer. The added weight of the rear mounted power unit acts as a counterweight for the additional weight added to the "C" frame in the front. The complete machine can be mounted and ready for operation in about one hour or less. (432) 333-9587, ezpadding.com



ALLU Group

ALLU Screener Crusher is a versatile processing attachment for a wheel loader, excavator or skid steer. ALLU Screener Crusher can screen, crush, pulverize, aerate, blend, mix, separate, carry, feed and load all in a one-step operation. With the ALLU Screener Crusher processing attachment, a basic machine can be

converted into a processing plant, increasing business opportunities and profits. The ALLU Screener Crusher processing attachment can process different kinds of materials like top soil, waste soil, contaminated soil, clay, peat and many other materials. (800) 939-2558, allu.net

Felco Industries

Felco Backfill Conveyor allows contractors to backfill open trenches faster, safer and easier. The excavator operator places material in the hopper, and sends it the length of the conveyor into the trench (past the trench box)



where the material is immediately accessible for compaction. Felco Backfill Conveyor increases the efficiency and profitability of a project by removing truck requirements from the trenching operation and eliminating spoil stockpiling to maximize digging time. It also helps prevent clean-up costs and potential damage to private property. (406) 728-9103, felco-ind.com

Rock Construction Equipment & Tools



Melfred Borzall

Need a high-performance, dependable mud motor? Melfred Borzall delivers. The Rock-It Mud Motor is designed specifically for

horizontal directional drilling and can be operated at slower speeds compatible with tri-cone bits. Featuring high torque to flow ratio, the Rock-It mud motor allows more drilling power with less fluid and accommodates rigs with as low as 30-gpm drill fluid flow. Now, even a mini HDD rig can drill rock. The Rock-It Mud Motor is available in sizes from 3 to 6 3/4 inches, with larger sizes available upon request. Melfred Borzall's Rock-It rental program features a fixed, known rental price up front and no hidden charges, like inspection fees or repair parts. Rent the Rock-It for as little as one week. (800) 558-7500, melfredborzall.com



Sharewell

Sharewell offers a 5-cutter version of its Jumbo Lo-Torque Hole Opener product – the LTX24x5. This version dramatically reduces impact loading on the cutters, which increases the product's working life. The 5-cutter version also reduces the

torque cycle while reaming, creating a very smooth running hole opener. The body is bi-directional and can be either pull or push

reamed. Ideal for pipeline projects, the Jumbo cutters offer large, sealed bearings for extended runs. (713) 983-9818, sharewell.com



Kenco

The Kenco Triple Tine Mechanical Grapple features three points of contact to safely lift irregular shaped objects. The unique design allows for a wide range of size capability. Kenco's patented actuator allows for hands-free operation in the lifting, moving and placing of irregular shaped objects such as rock. No hydraulics are necessary. The weight of the load provides the gripping power. The Triple Tine is available

in several models, with capacities ranging from 3,000 to 20,000 pounds. (800) 653-6069, kenco.com



Altas Copco

Designed with fewer moving parts for optimal reliability, the MB 1500 hydraulic breaker attachment is ideal for trenching, road work, demolition and secondary rock breaking. The MB 1500 offers a combination of high single blow energy and impact frequency of up to 640 blows per minute. At a service weight of 3,310

Rock Construction Equipment & Tools

pounds, the MB 1500 is suitable for carriers in the 17 to 29 metric ton weight class. The breaker accepts hydraulic input flow of 32 to 41 gallons per minute at operating pressures of 2,320 to 2,610 psi. The MB 1500 includes AutoControl, a monitoring system that allows the breaker to adapt its frequency and power output to match operating conditions. (413) 746-0020, atlascopco.com



American Pneumatic Tools

The APT Model 119 Trench Digger is used for digging clay, shale, hard pan and frozen ground. The Model 119 is the perfect tool for digging trenches to lay pipes, phone lines, for foundation work, temporary asphalt patch work, etc. The only difference among the APT Model 117 Paving Breaker, the Model 118 Clay Digger and the Model 119 Trench Digger is the handle. All feature built-in oilers, automatic valves and latch-type retainers. APT Model 119's extended "T" handle makes dig-

ging trenches and other below surface applications less cumbersome, which will also alleviate operator stress and get the job done more quickly and efficiently. (800) 532-7402, apt-tools.com



Chicago Pneumatic Construction Tools

Featuring 12 models, the new CP breaker line covers a wide variety of applications, including trenching, road construction, landscaping, building renovation, demolition and secondary breaking. Suitable for excavators in the 26 to 75 metric ton weight class, three heavy-duty models are available with service weights ranging from 4,850 to 9,259 pounds. Four medium breakers weigh between 1,213

and 3,527 pounds, for use on 9- to 34-metric ton carriers. Five light models round out the line, with service weights from 209 to 827 pounds. (413) 493-7336, cpconstructiontoolsusa.com



American Augers

The heavy-duty Rock Head is a durable cutting head ideal for bores through soft rock formations, harp pan, shale, gravel, small boulders and similar intrusive ground conditions up to 6,000 psi. The design benefit is that the "vee" shape of the head provides a self-centering action, which helps to main-

tain ideal line and grade. The head also features Tungsten carbide bullet bits that can be used at aggressive drill angles. Available sizes include 4-54 inch (depending on Hex size 1 3/8 to 4 inch). (800) 324-4930, americanaugers.com



INROCK

INROCK, whether drilling in soft to hard ground, provides drilling tools, equipment and services to directional drilling contractors worldwide. INROCK has the technology and support to make your bores profitable. Based in Houston, TX, INROCK also has offices in Mexico, Canada and Europe. All products come with

24/7 service and support. (713) 690-5600, inrock.com



Vermeer

The Vermeer RS6/RS8 is a specialized rock drilling head assembly utilizing a tri cone roller bit and drill head housing. The tri cone bit is driven using a shaft and bit adapter. The drill

head housing is offset from the shaft and remains stationary while drilling, constantly causing a steering action. Directional control is accomplished by changing the orientation of the housing using a jaw clutch mechanism to engage the housing to the drill stem. The RS6/RS8 allows an HDD machine to be quickly converted to a rock drilling machine by simply having the tool on site. (880) 837-6337, vermeer.com



Ditch Witch

The Tornado Bit is a long-lasting, all-purpose bit designed for use in a variety of soils, including sandstone, chunk rock and hard soils. There are nine Tornado Bits, from the 3-inch up to a 6.4-inch, designed for use with nearly all of Ditch Witch's HDD machines. As part of a complete line

of high-quality downhole tools, Tornado Bits and the rest of the extensive line of Ditch Witch drilling bits are engineered to provide long-lasting productivity. (800) 654-6481, ditchwitch.com



Bor-It Mfg.

The Combination Head is ideal for sand, dirt, clay and soft shale applications. This is the consummate general purpose style head. Features include: replaceable carbide teeth and chippers for long life and performance; wingcutters will over-cut for casing and provide for easy access to the head; head diam-

eters from 4 to 72 inches; and 1 1/8- to 5-inch Hex drive available. (800) 289-6639, bor-it.com

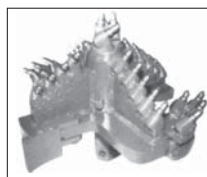

Barbco

Barbco Cutting Heads deliver a 100 percent cutting pattern, reducing drag and torque to your boring machine, maximizing control of line and grade. The BBC-45 Heavy Duty Rockhead features: replaceable bullet bits; a pilot hole design; wipers to remove

cuttings 16 inch and larger; a replaceable shank; and a changeable shank size. (800) 448-8934, barbco.com



Sandvik

There is a Sandvik hydraulic hammer for virtually any breaking application that requires a boom-mounted percussive tool. From the advanced in-series hammers for mini-excavators, whose tools are so strong they are guaranteed for life against breakage, to the extra heavy-duty G-series for excavators

from 27-100 tons in weight, there is a reliable, low-maintenance, easy-to-fit, high-performance Sandvik hammer certain to raise productivity, optimize results and give a lower cost per ton of material broken. (404) 589-3800, miningandconstruction.sandvik.com

Rock Construction Equipment & Tools

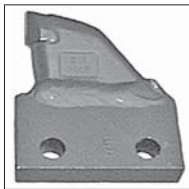

Ballantine

Ballantine offers a wide selection of cutting teeth and manufactures cup teeth with embedded tungsten carbide hard facing for nearly all trenchers. Also available are many styles of carbide rock teeth, such as: carbide rotary teeth, carbide Terminator teeth and ground breakers. A wide variety of adapters for carbide teeth are also in stock. (763) 427-3959, ballantineinc.com



Underground Tools Inc.

UTI offers high quality trencher parts including chains, cutting systems and sprockets, all coupled with exclusive DirtSmart technical service. All parts are made with the finest steel and carbide available and heat treated to ensure strength. Trencher parts from UTI are lab tested and field-proven for durability. They meet or exceed manufacturer's specifications and are available for all makes and models of trenchers. (866) 488-DIRT, undergroundtools.com

Auger Boring



McLaughlin Group

The McLaughlin 54/50 auger delivers 950,000 pounds of forward thrust and 170,000 foot-pounds of peak torque in all soil types. The auger is ideally suited for cased auger boring projects ranging from 16 to 60 inches. The unit features

three hydraulic rams that provide infinitely variable speed and a split design of the hydraulics and powertrain provides for easier and faster positioning. A patented Operator Presence Control hydraulic clutch reduces spinback. (800) 435-9340, mightymole.com



Bor-It Mfg.

The Bor-It Model 60 Destroyer, the largest in the lineup, has a 180-hp diesel engine with a five-speed transmission. This machine offers a maximum torque output of 259,018 foot-pounds with a normal thrust of 1,206,374 pounds and bores a diameter range of 24 through 60 inches. The Model 60 Destroyer horizontal earth boring machine is packaged to provide extra power for those extra-rugged boring applications. With nine models of machines to offer, Bor-It can handle all your horizontal earth boring needs. Fast, easy handling, efficient, powerful and a unique split design – all are trademarks of Bor-It quality. (800) 289-6639, bor-it.com

With nine models of machines to offer, Bor-It can handle all your horizontal earth boring needs. Fast, easy handling, efficient, powerful and a unique split design – all are trademarks of Bor-It quality. (800) 289-6639, bor-it.com



American Augers

The 42-600 NG auger boring machine is equipped with a 114-hp Deutz F6L914 turbo-diesel engine. The basic unit is capable of 600,000 pounds of maximum thrust, and provides the operator up to 113,087 foot-pounds of

torque. It offers the rack and pinion system, Quik Tran, providing up to 10,000 pounds of push/pull at high speed, meaning there will be no dogging or winching during retract because the Quik Tran system engages directly to the machine track. The Quik Split frame design allows the machine to be separated into sections to accommodate lighter and faster lifts into and out of the bore pit, and aids the operator in being able to facilitate better and safer machine positioning. (800) 324-4930, americanaugers.com



Barbco

The Model 72/84-2.6 MXHD auger boring machine is designed to work with Barbco's PATH-FINDER. Barbco's Extreme Heavy Duty Auger Boring machine boasts 2.6 million pounds of thrust and can take on some

of the toughest bores. The Model 72/84 is equipped with a 350-hp Caterpillar C9 Acert, liquid cooled 6-cylinder turbocharged engine. With 10-speed transmission, the 72/84 produces 1,809,561 pounds of continuous thrust and 300,999 foot/pounds of maximum torque at 8 rpm in first gear. Cutting attachments for this machine range from a boring machine tunneling attachment to a small boring unit (SBU) for boring through hard rock to a rock head for digging in soft rock. (800) 448-8934, barbco.com



Akkerman

The Guided Boring method installs small diameter pipes with grade and alignment precision. Akkerman Guided Boring Machines (GBM) are used in conjunction with a specially designed theodolite guidance system to provide

extremely accurate pipe installation. Akkerman's GBM is extremely versatile and can be used for a variety of applications. The 240A, single stage "long" jacking frame is designed to work in a 12-foot plus shaft and can be used as a stand alone unit or in conjunction with an auger boring rig. (800) 533-0386, akkerman.com



The Robbins Company

Formerly only for hard rock boring, the Robbins Small Boring Unit (SBU-A) is now offered with a specialized mixed ground cutterhead. The new design, available on all current models, allows for excavation in soft ground with cobbles and boulders. The SBU-A, in diameters from 24 to 72 inches, is a type of boring attachment for use with any standard Auger Boring Machine (ABM). The machine is welded to the lead steel casing at machine launch. The ABM provides torque to the SBU-A while forward thrust is provided through the casing. Spoils are removed using a full-face auger. (440) 248-3303, TheRobbinsCompany.com